

FIREPLACES
INSERTS
STOVES

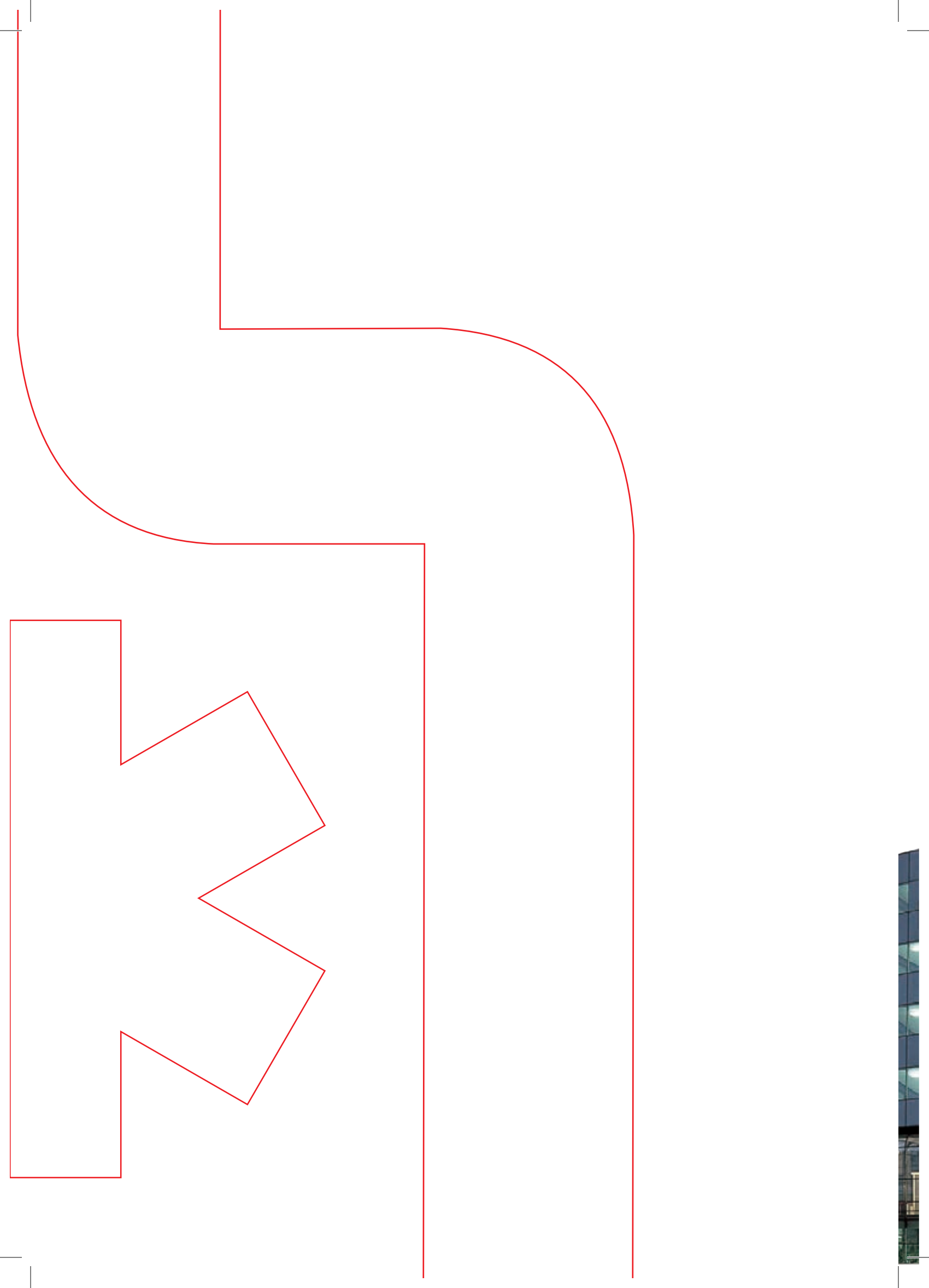

EDILKAMIN

A TRUSTED BRAND FOR OVER 55 YEARS

Edilkamin is a group employing over 400 people, with more than 80 sales agents and over 400 technical assistance centers.

Ever careful to the needs of a continuously evolving market, Edilkamin proposes technologically advanced solutions featuring sophisticated design, in line with contemporary necessities.

Edilkamin exports technology and design with success to over 30 countries worldwide.



EDILKAMIN



2 LAVAGNO (Verona)

Technical Centre and Research & Development Lab.



3 GABBIONETA BINANUOVA (Cremona)

Production Unit and Research & Development Unit for obtaining important certifications.



4 CONTROGUERRA (Teramo)

Logistics centre for managing services in Central-Southern Italy.





1 LAINATE

Head office, Sales and Marketing divisions, Accounts, Information & Technology departments, classrooms for technical and sales training, and showroom covering over 1,000 m² with the complete range on display.



8

5 GIRONA (Spagna)

Edilkamin Iberica, commercialisation centre for Spain and Portugal

6 SARVAR (Ungheria)

Edilkamin International, production unit

7 BUDAÖRS (Ungheria)

Edilkamin International, Show room.

8 ATENE (Grecia)

Edilkamin Hellas, showroom and commercialisation centre for Greece.



AFTER-SALES

After-sales support is a crucial service: the Edilkamin staff offers timely support whenever required, for responding to any need.

TRUST AND RELIABILITY

Edilkamin supports customers throughout all phases, from selection of the product to its installation. Moreover, where required, qualified personnel is always on hand for any need.

TESTING AND TRACEABILITY

Every Edilkamin product is tested to guarantee its maximum efficiency and reliability. The traceability system allows for tracking the product, individual component and assembly operator to solve any problems in the shortest possible time.

CERTIFICATION

Products, in addition to the CE marking and according to rules:

- EN 13229_Fireplaces
- EN 13240_Wood-stoves
- EN 14785_Pellet stoves
- EN 303-5_Boilers

in accordance with need, shall comply with the criteria set by:

- Flamme Verte:** French certification stamp of quality
- Blmsch:** German requirement for domestic heating appliance
- 15 a B-VG:** Austrian emissions law
- EAC:** Eurasian Countries (Russia, Kazakhstan, Belarus) conformity certification
- BAFA:** German Energy Ministry
- EKO SKLAD:** Slovenian Ministry of Energy

All Edilkamin products meet the criteria of energy efficiency classes

A++ , A+ , A

According to the UE 2015-1186/1187.

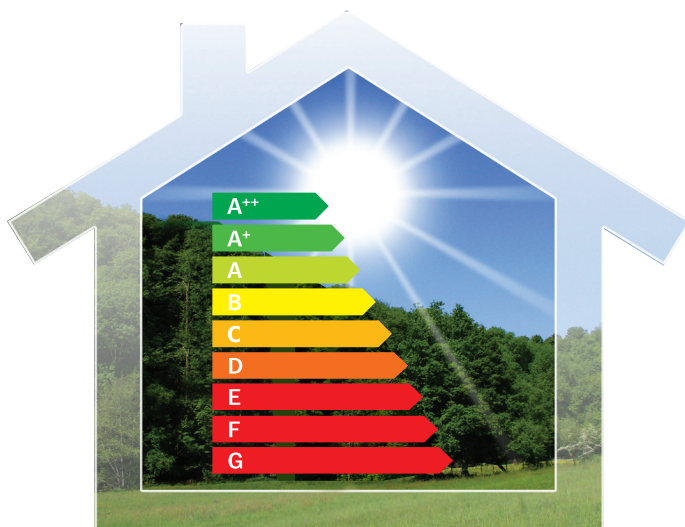

Saving QUALITY ECOLOGY

WHY WOOD?

It's easy to find
It's a natural raw material
It's the cheapest fuel
It offers a very suggestive environment

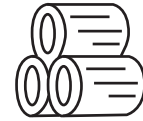

An Evolving TECHNOLOGY

AIR DIFFUSER

Heat and adjustable light for made-to-measure comfort.

For wood burning fireplaces and stoves, Edilkamin has made available an AIR DIFFUSER, an electronic control unit managed via remote control, allowing you to adjust hot air ventilation and lighting intensity, creating the perfect atmosphere. AIR DIFFUSER manages up to 2 fans: each fan can duct hot air up to a maximum of 8 metres (with a single duct) or 4 metres (two ducts).

DESIGN VENTS

“Beauty” distributing heat. Edilkamin stoves, fireplaces and inserts can distribute hot air to heat multiple rooms. Today, technology meets design, with two new types of vents:

- for hot air circulation in the counter hood.
- to diffuse hot air in the room.

COMPENSATION VENTS

To position on the fireplace counter hood. Can be combined with the design vents to diffuse hot air.

TRATTO PUNTO



LABEL



cm 60 x 7 h

cm 90 x 7 h

DUCTING VENTS

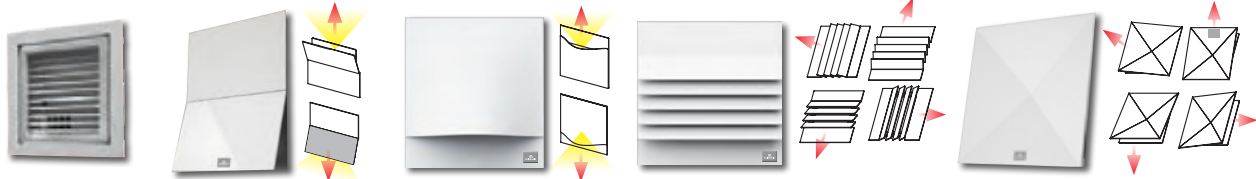

BASIC V*
cm 20 x 20

SPLIT V* - SPLIT
cm 20 x 20

BENT V* - BENT
cm 20 x 21,5 h

SHARP V* - SHARP
cm 20 x 20

ORIGAMI V* - ORIGAMI
cm 20 x 20

* With integrated fan





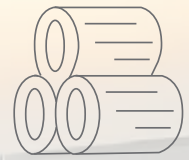

Hot air heating

IN JUST ONE OR
MORE DUCTED ROOMS

Edilkamin fireplaces, inserts and stoves allow for the rooms in which they are installed to be heated by radiation, while also diffusing hot air through the frontal grills using fans.

Certain models even allow for the hot air to be channelled into adjacent rooms.



FIREPLACES
INSERTS
STOVES

INDEX P. 62



Windo3 85

13,2 kW_345 m³_92x63xh150 cm

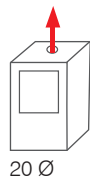

Windo3 P50

12 kW_315 m³_58x92xh150 cm

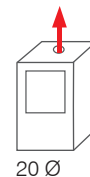

WOOD FIREPLACES

Glass on three sides

- _ Combustion chamber in Ecoveram
- _ Ductable hot air
- _ Combustion air adjustment
- _ Easy glass cleaning

Optional:

- _ Kits for warm-air ducting:
 - Kit 1/bis, kit 4/bis, kit 5/bis
 - KIT AIR DIFFUSER
- _ Ducting vents:
 - Basic V, Split V, Bent V, Sharp V, Origami V

WOOD FIREPLACES

Glass on three sides

- _ Combustion chamber in Ecoveram
- _ Ductable hot air
- _ Combustion air adjustment
- _ Easy glass cleaning

Optional:

- _ Kits for warm-air ducting:
 - Kit 1/bis, kit 4/bis, kit 5/bis
 - KIT AIR DIFFUSER
- _ Ducting vents:
 - Basic V, Split V, Bent V, Sharp V, Origami V



Kit 1/bis, kit 4/bis, kit 5/bis

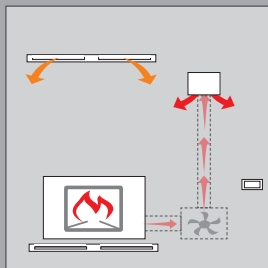

KIT AIR DIFFUSER

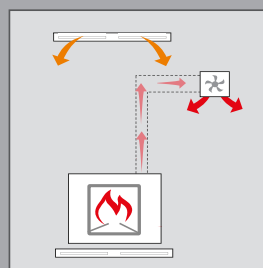

Basic V, Split V, Bent V, Sharp V, Origami V





Windo2 75

13,2 kW_345 m³_94x63xh150 cm L/R

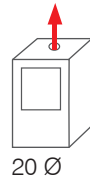

Windo2 95

14,7 kW_385 m³_114x63xh150 cm L/R

Side Plus 50x50

12,4 kW_325 m³_60x60xh148 cm

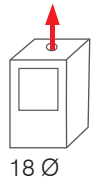

WOOD FIREPLACES

- _ Combustion chamber in Ecoveram
- _ Right or left corner glass
- _ Ductable hot air
- _ Combustion air adjustment
- _ Easy glass cleaning

Optional:

- _ Kits for warm-air ducting:
 - Kit 1/bis, kit 4/bis, kit 5/bis
 - KIT AIR DIFFUSER
- _ Ducting vents:
 - Basic V, Split V, Bent V, Sharp V, Origami V

WOOD FIREPLACES

- _ Combustion chamber in Ecoveram
- _ Sliding door, flat angled glass
- _ 1 hot air outlet
- _ Glass cleaning system
- _ Post-combustion system

Optional:

- _ Kits for warm-air ducting:
 - Kit 6/bis
- _ Ducting vents:
 - Basic V, Split V, Bent V, Sharp V, Origami V



Kit 1/bis, kit 4/bis, kit 5/bis

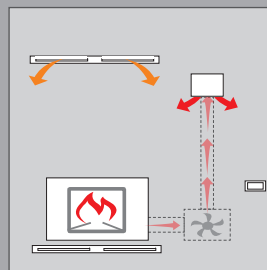

KIT AIR DIFFUSER



Kit 6/bis

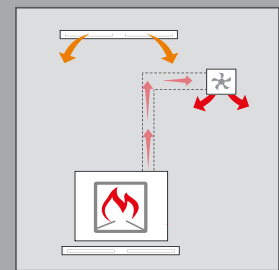

Basic V, Split V, Bent V, Sharp V, Origami V





Cristal 45

13 kW_340 m³_68x64xh161 cm

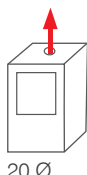

20 Ø

Cristal 76

15 kW_390 m³_98x65xh147 cm

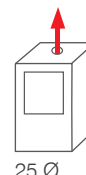

25 Ø



WOOD FIREPLACES

- _ Combustion chamber in Ecoveram
- _ 2 outputs for ducting hot air (kit optional)
- _ Provided with manual combustion-air regulation deflector
- _ Glass cleaning system

Optional:

- _ Ventilation kit to convert version N into forced ventilation
- _ Kits for warm-air ducting:
 - Kit 1/bis, kit 2/bis, kit 3/bis
- _ Ducting vents:
 - Basic V, Split V, Bent V, Sharp V, Origami V

WOOD FIREPLACES

- _ Combustion chamber in Ecoveram
- _ 2 outputs for ducting hot air (kit optional)
- _ Provided with manual combustion-air regulation deflector
- _ Glass cleaning system

Optional:

- _ Ventilation kit to convert version N into forced ventilation
- _ Kits for warm-air ducting:
 - Kit 1/bis, kit 2/bis, kit 3/bis
- _ Ducting vents:
 - Basic V, Split V, Bent V, Sharp V, Origami V



Kit 1/bis, kit 2/bis, kit 3/bis

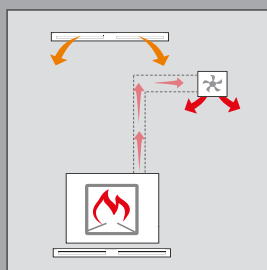

Basic V, Split V, Bent V, Sharp V, Origami V



Cristal 90

20,1 kW_525 m³_112x65xh168 cm

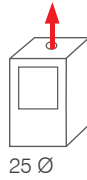

Double

12 kW_315 m³_98x67xh147 cm

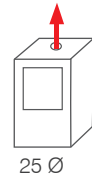

WOOD FIREPLACES

- _ Combustion chamber in Ecoveram
- _ 4 outputs for ducting hot air (kit optional)
- _ Provided with manual combustion-air regulation deflector
- _ Glass cleaning system

Optional:

- _ Ventilation kit to convert version N into forced ventilation
- _ Kits for warm-air ducting:
 - Kit 4/bis, kit 5/bis
- _ Ducting vents:
 - Basic V, Split V, Bent V, Sharp V, Origami V

WOOD FIREPLACES

- _ Combustion chamber in Ecoveram
- _ Two-sided hearth with sliding door and hinged door
- _ 2 outputs for ducting hot air (kit optional)
- _ Glass cleaning system

Optional:

- _ Ventilation kit to convert version N into forced ventilation
- _ Kits for warm-air ducting:
 - Kit 1/bis, kit 2/bis, kit 3/bis
- _ Ducting vents:
 - Basic V, Split V, Bent V, Sharp V, Origami V



Kit 1/bis, kit 2/bis, kit 3/bis



kit 4/bis, kit 5/bis

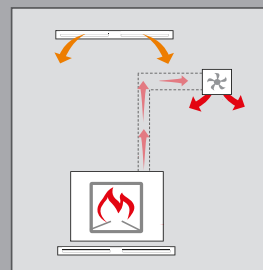

Basic V, Split V, Bent V, Sharp V, Origami V



Flat 100

12 kW_315 m³_125x59xh134 cm

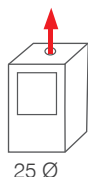

Flat 120

14 kW_365 m³_143x59xh134 cm

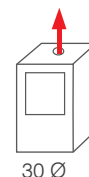

WOOD FIREPLACES

- Combustion chamber in Ecoveram.
- 4 outputs for ducting hot air (kit optional),
- provided with manual combustion-air regulation deflector
- complete sliding door in ceramic glass
- Glass cleaning system

Optional:

_ Ventilation kit to convert version N into forced ventilation

_ Kits for warm-air ducting:

- Kit 1/bis, kit 2/bis, kit 3/bis, Kit 4/bis, kit 5/bis

_ Ducting vents:

- Basic V, Split V, Bent V, Sharp V, Origami V



Kit 1/bis, kit 2/bis,
kit 3/bis



kit 4/bis, kit 5/bis

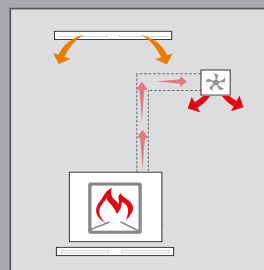

Basic V, Split V, Bent V,
Sharp V, Origami V





NEW

IC Tekno

1 N/V - front

15,2 kW_395 m³_95x63,5x155h cm

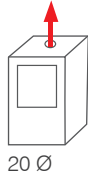

NEW

IC Tekno

2 N/V - glass on one side

15,2 kW_395 m³_95x66x155h cm



WOOD FIREPLACES

- _ Cast iron combustion chamber
- _ 2 outputs for ducting hot air (kit optional)
- _ Operation via natural convection or forced ventilation
- _ Post-combustion system

Optional:

- _ Kits for warm-air ducting:
 - Kit 1/bis, kit 2/bis, kit 3/bis



Kit 1/bis, kit 2/bis, kit 3/bis

NEW

IC Tekno

3 N/V - prismatic

15,2 kW_395 m³_95x62x155h cm







NEW

Forte Up2

15,2 kW_395 m³_98x60xh160 cm

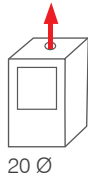

NEW

Status Up2

15,2 kW_395 m³_95x60xh160 cm

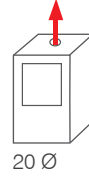

WOOD FIREPLACES

- _ Cast iron combustion chamber
- _ 4 outputs for ducting hot air (kit optional)
- _ With synoptic front panel (version V)
- _ Post-combustion system

Optional:

- _ Ventilation kit to convert version N into forced ventilation
- _ Kits for warm-air ducting:
 - Kit 1/bis, kit 2/bis, kit 3/bis
 - Kit 4/bis, kit 5/bis
- _ Ducting vents:
 - Basic V, Split V, Bent V, Sharp V, Origami V

WOOD FIREPLACES

- _ Cast iron combustion chamber
- _ 4 outputs for ducting hot air (kit optional)
- _ With synoptic front panel (version V)
- _ Post-combustion system

Optional:

- _ Ventilation kit to convert version N into forced ventilation
- _ Kits for warm-air ducting:
 - Kit 1/bis, kit 2/bis, kit 3/bis
 - Kit 4/bis, kit 5/bis
- _ Ducting vents:
 - Basic V, Split V, Bent V, Sharp V, Origami V



Kit 1/bis, kit 2/bis, kit 3/bis



kit 4/bis, kit 5/bis

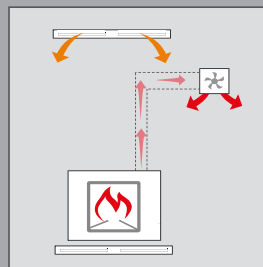

Basic V, Split V, Bent V, Sharp V, Origami V



NEW Titano Up2

15,2 kW_395 m³_96x60xh160 cm

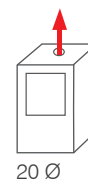

WOOD FIREPLACES

- _ Cast iron combustion chamber
- _ Right or left corner glass
- _ 4 outputs for ducting hot air (kit optional)
- _ With synoptic front panel (version V)
- _ Post-combustion system

Optional:

- _ Ventilation kit to convert version N into forced ventilation
- _ Kits for warm-air ducting:
 - Kit 1/bis, kit 2/bis, kit 3/bis, Kit 4/bis, kit 5/bis
- _ Ducting vents:
 - Basic V, Split V, Bent V, Sharp V, Origami V



Kit 1/bis, kit 2/bis, kit 3/bis



kit 4/bis, kit 5/bis

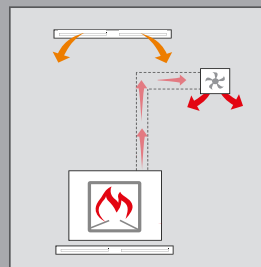

Basic V, Split V, Bent V, Sharp V, Origami V



Airfire*

10 kW_260 m³_92x65-xh147 cm

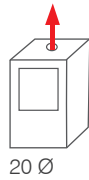

Flat hatch



Airfire*

10 kW_260 m³_84x67xh147 cm

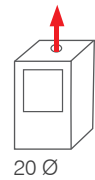

Prismatic hatch



WOOD FIREPLACES

- Base structure and hood in steel,
vertical sliding opening
- combustion chamber in Ecokeram
 - natural convection
 - screen-printed ceramic glass
 - glass cleaning system

* While stocks last





Screen Evo 80/2

10,4 kW_270 m³_93x53xh75 cm

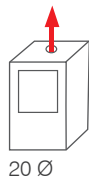

Screen Evo 100

14,6 kW_380 m³_113x53xh75 cm

Screen Up 80/2

10,4 kW_270 m³_93x53xh75 cm

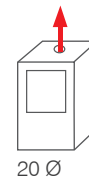

Screen Up 100*

14,6 kW_380 m³_113x53xh75 cm



WOOD FIREPLACES

Side opening

- _ Combustion chamber in Ecokeram
- _ Ductable hot air (optional kit)
- _ 2 compensation vents (LABEL)

Optional:

- _ Thermostat valve to adjust combustion
- _ Height adjustable stand
- _ Kits for warm-air ducting:
 - Kit 1/bis, kit 2/bis, kit 3/bis
 - KIT AIR DIFFUSER
- _ Ducting vents:
 - Basic V, Split V, Bent V, Sharp V, Origami V

WOOD FIREPLACES

Flip-up opening

- _ Combustion chamber in Ecokeram
- _ Ductable hot air (optional kit)
- _ 2 compensation vents (LABEL)

Optional:

- _ Thermostat valve to adjust combustion
- _ Height adjustable stand
- _ Kits for warm-air ducting:
 - Kit 1/bis, kit 2/bis, kit 3/bis
 - KIT AIR DIFFUSER
- _ Ducting vents:
 - Basic V, Split V, Bent V, Sharp V, Origami V

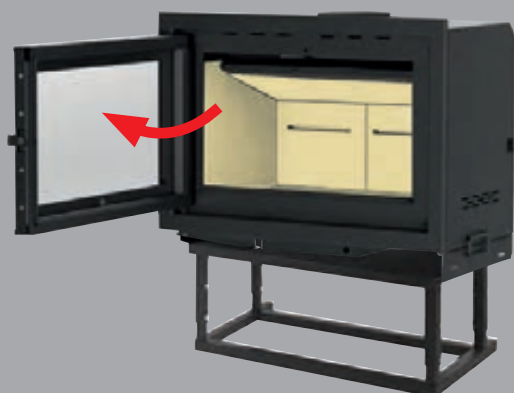



Kit 1/bis, kit 2/bis,
kit 3/bis

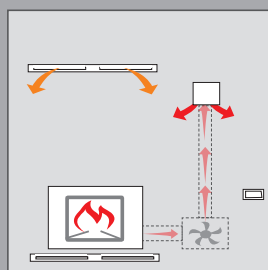

KIT AIR DIFFUSER

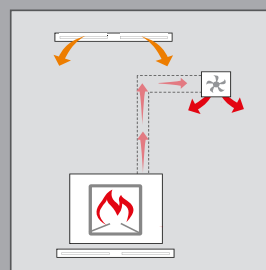

Basic V, Split V, Bent V,
Sharp V, Origami V

Inserts



Wood inserts are the ideal solution for transforming an old fireplace that releases smoke, doesn't provide enough heat or consumes too much wood, into an efficient, clean and economical heating machine. Wood inserts can duct hot air into adjacent rooms. Both solutions increase heat output, reduce emissions and reduce heating costs.





Firebox Luce Plus

- 54 • 9,6 kW_250 m³_65x45xh61 cm
- 62 • 9,6 kW_250 m³_70x50xh68 cm

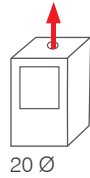

Firebox Deco

9,6 kW_250 m³_65x45xh54 cm

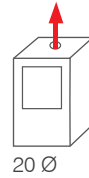

WOOD INSERTS

- _ Cast iron combustion chamber
- _ 2 outputs for ducting hot air (kit optional)
- _ Operation via natural convection or forced ventilation
- Glass cleaning system
- Post-combustion system

Optional:

- _ Kits for warm-air ducting:
 - Kit 1, kit 2, kit 3
- _ Ducting vents:
 - Basic V, Split V, Bent V, Sharp V, Origami V

WOOD INSERTS

- _ Cast iron combustion chamber
- _ 2 outputs for ducting hot air (kit optional)
- _ forced ventilation
- Glass cleaning system
- Post-combustion system

Optional:

- _ Kits for warm-air ducting:
 - Kit 1, kit 2, kit 3
- _ Ducting vents:
 - Basic V, Split V, Bent V, Sharp V, Origami V



kit 1,kit 2,kit 3

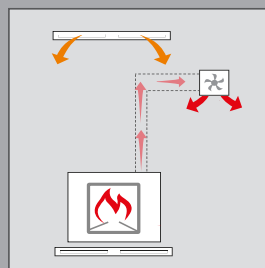

Basic V, Split V, Bent V, Sharp V, Origami V



Firebox Riga

54 • 9,6 kW_250 m³_65x45xh54 cm

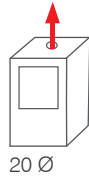

49 • 9,6 kW_250 m³_71x45xh49 cm



Energy
A++
A+
A
B
C
D
E
F
G



Energy
A++
A+
A
B
C
D
E
F
G

WOOD INSERTS

- _ Cast iron combustion chamber
- _ 2 outputs for ducting hot air (kit optional)
- _ Forced ventilation
- Glass cleaning system
- Post-combustion system

Optional:

- _ Kits for warm-air ducting:
 - Kit 1, kit 2, kit 3
- _ Ducting vents:
 - Basic V, Split V, Bent V, Sharp V, Origami V

Glass on one side



kit 1, kit 2, kit 3

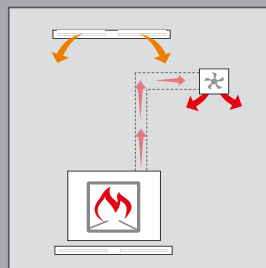

Basic V, Split V, Bent V,
Sharp V, Origami V





Kubicalor Piana

9,6 kW_250 m³_69x49xh66 cm

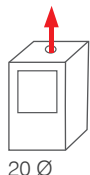

Kubicalor Ecostar

9,6 kW_250 m³_76x45xh54 cm

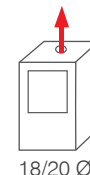

WOOD INSERTS

- _ Cast iron combustion chamber
- _ 2 outputs for ducting hot air (kit optional)
- _ forced ventilation
- _ Post-combustion system

Optional:

- _ Kits for warm-air ducting:
 - Kit 1, kit 2, kit 3

Kubicalor Sprint

9,6 kW_250 m³_70x45xh55,5 cm

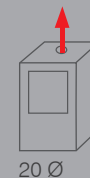

Kit 1, Kit 2, Kit 3





Grey steel

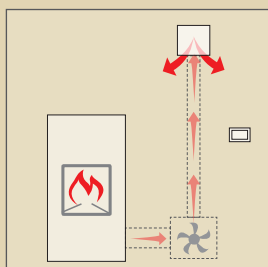

KIT AIR DIFFUSER

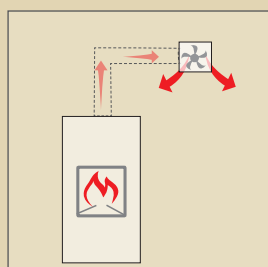

Basic V, Split V, Bent V,
Sharp V, Origami V



Soapstone



Black steel



Bronze steel



Tally 8

8 kW_210 m³_50x50xh128 cm

h131cm (Soapstone)

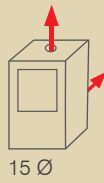

WOOD BURNING STOVES

- _ Vermiculite combustion chamber
- _ Automatic door closure with shock absorber
- _ High yield combustion compartment
- _ Natural convection
- _ Wood compartment
- _ Combustion air adjustment via command

Optional:

- _ Automatic switch on kit
- _ Cast iron combustion chamber
- _ Kit Air Diffuser
- _ Ducting vents:
Split V, Bent V, Origami V, Sharp V, Basic V

Tally 8 Up

_ Round glass

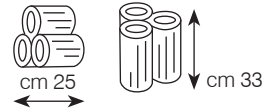

Bronze steel



_ Black steel wooden drawer kit

Tally 8 (optional)
Tally 8 Up



Grey steel



Black steel



Soapstone





Soapstone

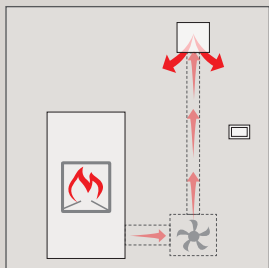

KIT AIR DIFFUSER

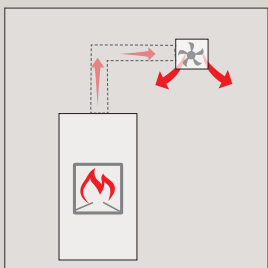

Basic V, Split V, Bent V,
Sharp V, Origami V



Grey steel



Black steel



Bronze steel



Tally 8 Up s

8 kW _210 m³ _50x50xh176 cm

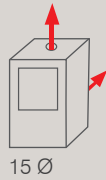

h179 cm (Soapstone)

_ Round glass

WOOD BURNING STOVES

- _ Vermiculite combustion chamber
- _ Automatic door closure with shock absorber
- _ High yield combustion compartment
- _ Natural convection
- _ Wood compartment
- _ Combustion air adjustment via command

Optional:

- _ Automatic switch on kit
- _ Cast iron combustion chamber
- _ Kit Air Diffuser
- _ Ducting vents:
Split V, Bent V, Origami V, Sharp V, Basic V

Prepared for accumulation (kit optional)

The top with refractory rings allows prolonged heat accumulation to heat the house, even for hours after the last wood was loaded. Load at night and a new switch switches on in the morning.

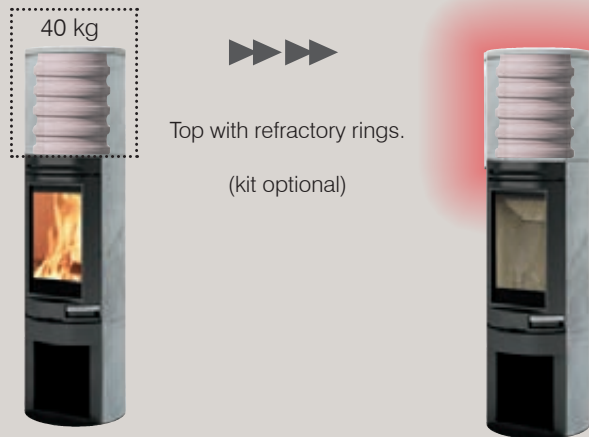

_ Black steel wooden drawer kit
Tally 8 Up s
Tally 8 s (optional)

Tally 8 s

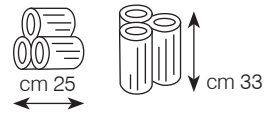

Black steel



Grey steel

Soapstone

Bronze steel

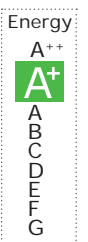



Fiord*

8 kW_210 m³_47x41,5x133,5 cm

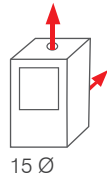

WOOD BURNING STOVES

- _ Vermiculite combustion chamber
- _ Automatic door closure with shock absorber
- _ Natural convection
- _ Wood compartment
- _ Combustion air adjustment via command

Optional:

- _ Automatic switch on kit
- _ Cast iron combustion chamber
- _ Kit Air Diffuser
- _ Ducting vents: Split V, Bent V, Origami V, Sharp V, Basic V

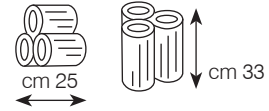

* While stocks last



Black steel and soapstone

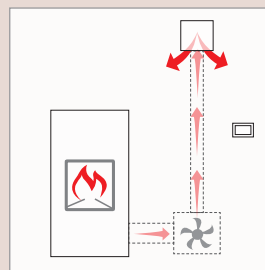

KIT AIR DIFFUSER

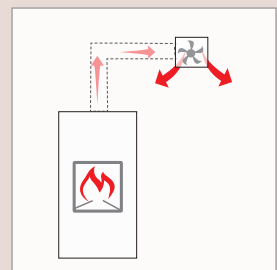

Basic V, Split V, Bent V, Sharp V, Origami V

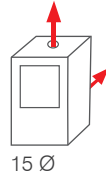

Ninfa

9 kW_235 m³_52x52xh95 cm

WOOD BURNING STOVES

- _Cast iron combustion chamber
- _Removable rings for heating food

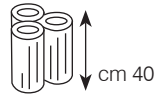

Bordeaux ceramic



Beige ceramic

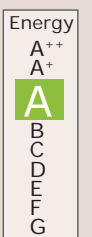

Dafne Oven

7,2 kW_190 m³_44x45x122 cm



bordeaux ceramic



leather ceramic

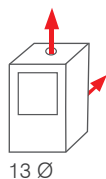

Dafne

7,2 kW_ 190 m³_ 44x45x92 cm

WOOD BURNING STOVES

- _ Cast iron combustion chamber
- _ Removable rings for heating food

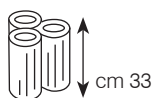

leather ceramic



bordeaux ceramic





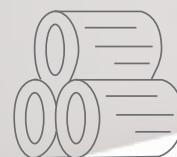

Hot water heating

WITH WATER ALL THE HOUSE

Edilkamin stoves and fireplaces produce hot water that can be used to supply all of the radiators and underfloor heating panels throughout the entire house. They can be connected to existing systems, and can even be used to supplement gas boilers and modern solar panels.

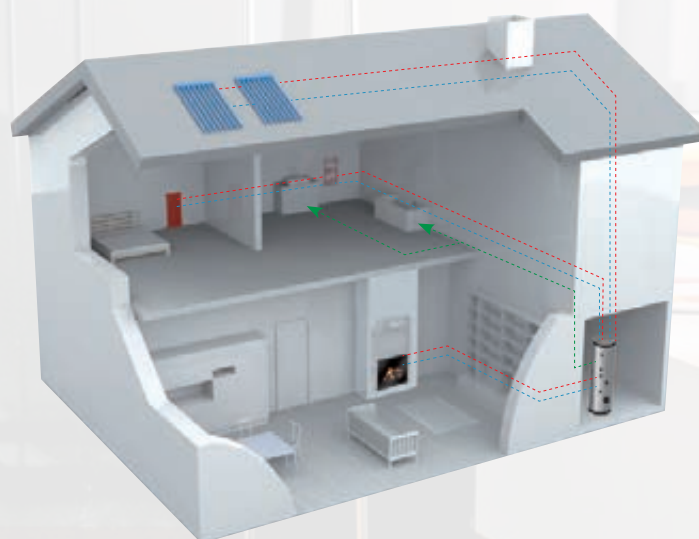

THERMO-FIREPLACES

THERMO-STOVES

INDEX P. 62



H₂Oceano 15

16,6 kW_8,2 kW (H₂O)_435 m³_74x62xh135 cm

H₂Oceano 23

23 kW_13,3 kW (H₂O)_600 m³_88x68xh147 cm

H₂Oceano 28

28,1 kW_17,4 kW (H₂O)_730 m³_106x78xh147 cm

WOOD THERMO-FIREPLACES

- _Cast iron and steel combustion chamber
- _All-glass front
- _Spit unit with steel rod
- _Post-combustion system
- _Coil and Safety valve,
for installation with closed tank (CS versions)

Optional:

- _Hydraulic kits (Page 50)

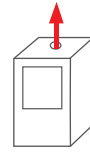

18 Ø (H₂oceano 15)
22 Ø (H₂oceano 23)
25 Ø (H₂oceano 28)



“Backpack” hydraulic kit V





Acquatondo 22

23 kW_13,3 kW (H₂O)_m³ 600_cm 80x68xh138,5

Acquatondo 29

28,1 kW_17,4 kW (H₂O)_m³ 730_cm 99x78xh138,5

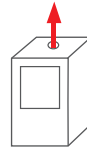

20 Ø (Acquatondo 22)
25 Ø (Acquatondo 29)

WOOD THERMO-FIREPLACES

- _ Cast iron and steel combustion chamber
- _ Spit unit with steel rod
- _ Coil and Safety valve,
for installation with closed tank (CS versions)

Optional:

- _ Hydraulic kits (Page 50)

Plus
22_22 cs _29_29 cs



Prismatic
22_29_29 cs



Glass on one side
29







Idro 30

14,8 kW_8,6 kW (H₂O)_m³ 385_cm 65x53x99h

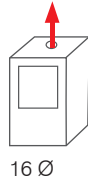

16 Ø

Idro 50

16,6 kW_8,2 kW (H₂O)_m³ 435_cm 77x66x138h

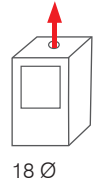

18 Ø

Energy
A⁺⁺
A⁺
A
B
C
D
E
F
G



Energy
A⁺⁺
A⁺
B
C
D
E
F
G



WOOD THERMO-FIREPLACES

- _ Cast iron and steel combustion chamber
- _ Spit unit with steel rod
- _ Coil and Safety valve,
for installation with closed tank (CS versions)

Optional:

- _ Hydraulic kits (Page 50)





Flamma

14,2 kW_9,7 kW(H₂O)_370 m³_63x56xh134 cm

23,6 kW_14,6 kW(H₂O)_615 m³_63x56xh134 cm

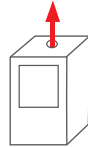

15 Ø

WOOD THERMO-STOVES

- _ Steel and vermiculite combustion chamber
- _ Automatic door closure with shock absorber
- _ No expansion tank
- _ Combustion-air regulation
- _ Coil and Safety valve, for installation with closed tank (CS versions)

Optional

- _ Ventilation kit
- _ Hydraulic kits (Page 50)

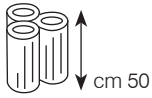
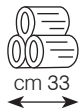

Bordeaux ceramic



Dark grey ceramic



Parchment ceramic



Cream white ceramic

HYDRAULIC KITS Open expansion tank

KIT A1

H₂Oceano 15_23_28, Acquatondo 22_29, Idro 30, Idro 50, Flamma

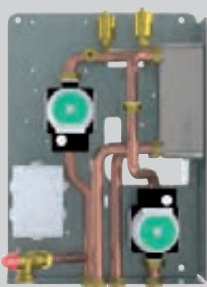

For combined installation with a second boiler without domestic hot water production

KIT C

H₂Oceano 15_23_28, Acquatondo 22_29, Idro 30, Idro 50, Flamma

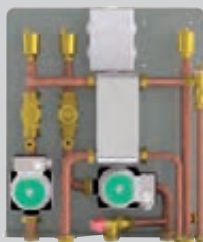

For separating primary circuit from secondary circuit and HSW.

KIT B

H₂Oceano 15_23_28, Acquatondo 22_29, Idro 30, Idro 50, Flamma



For separating primary circuit from secondary circuit and instant production of HSW.

KIT V

H₂Oceano 15_23_28

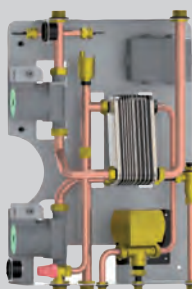

For combined installation with a second boiler with domestic hot water production

Closed expansion tank

KIT D

H₂Oceano 15_23_28 cs, Acquatondo 22_29 cs, Idro 30 cs, Idro 50 cs, Flamma 14_24 cs



For installing thermo fireplaces, thermo stoves and wood boilers; suited for separating primary circuit from secondary circuit and HSW production.

SAFETY KIT

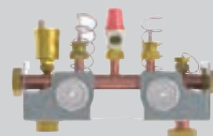

To be installed at a maximum distance of 50 cm from the heat generator.

KIT R: Flamma cs

For installing a single heat source without domestic hot water production.

KIT RW: Flamma cs

For installing a single heat source with instantaneous domestic hot water production.

KIT R2: Flamma cs

For combined installation with a second boiler without domestic hot water production with system separator.

KIT RW2: Flamma cs

For combined installation with a second boiler with domestic hot water production and system separator.

FIREPLACES

Windo2 75

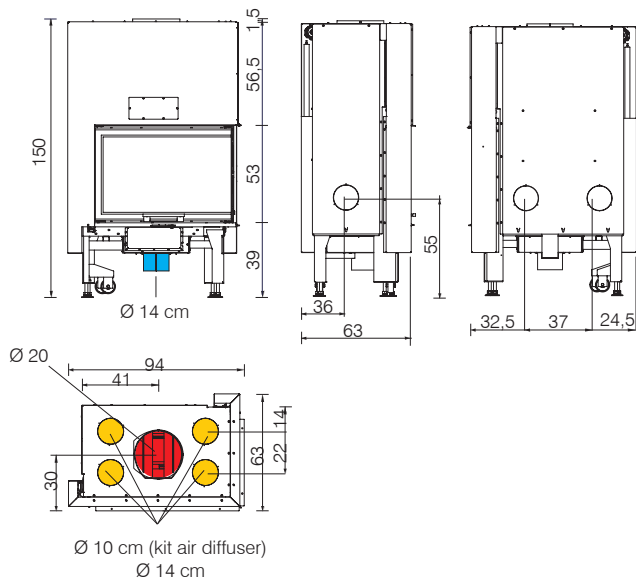

Windo2 95

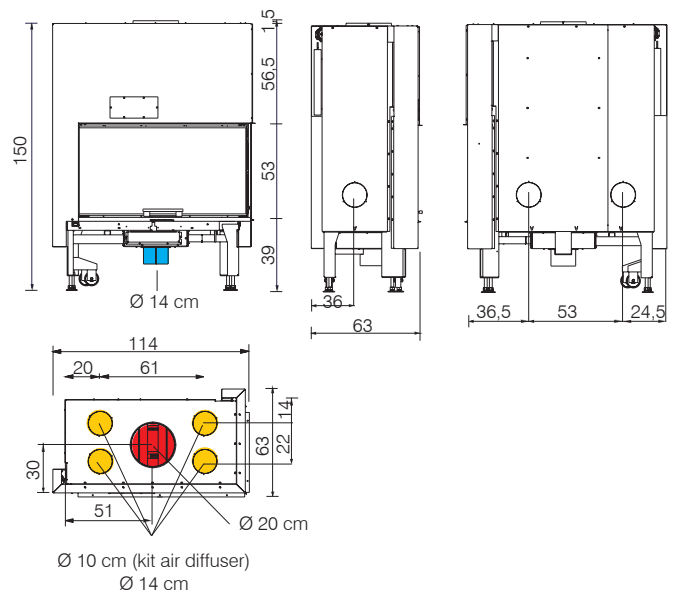

Windo3 P50

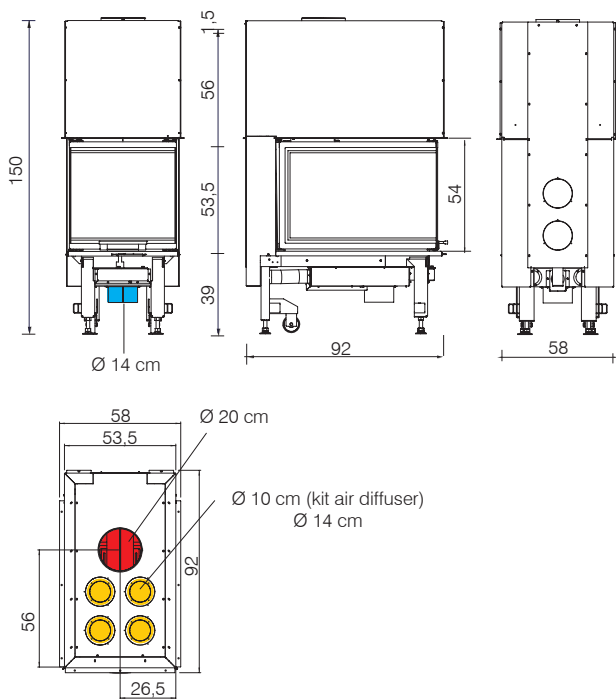

Windo3 85

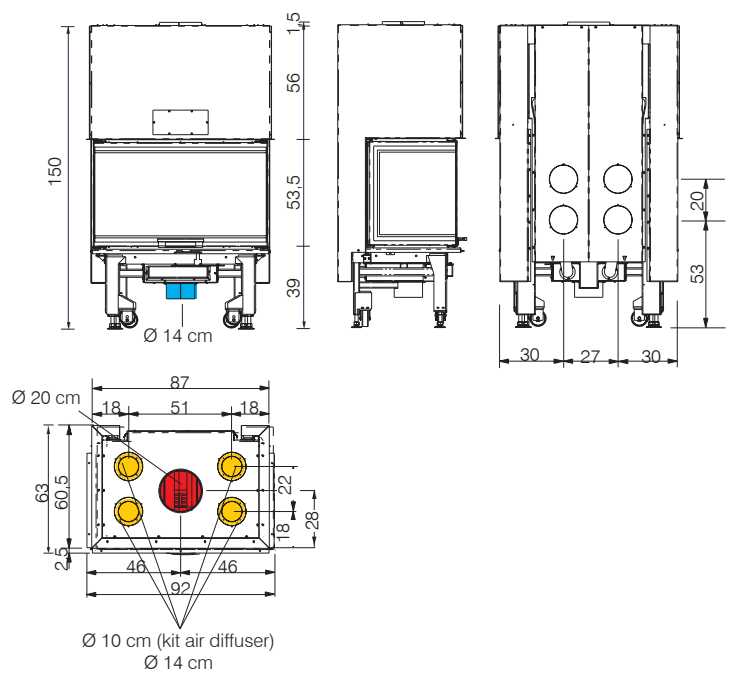

● External air intake

● Smoke outlet

● Hot air outlet

FIREPLACES

Side Plus 50x50

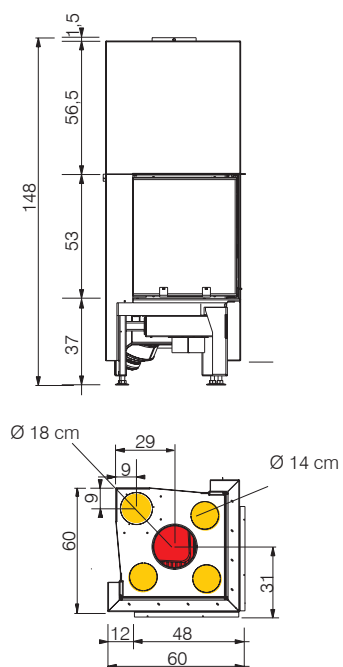

Airfire

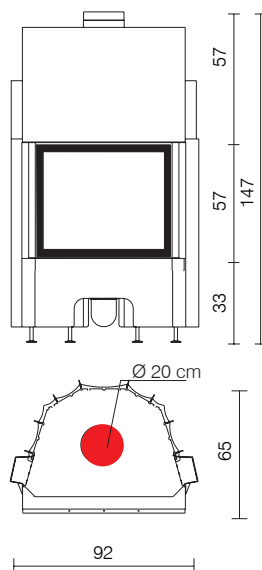

**Airfire
prismatic**

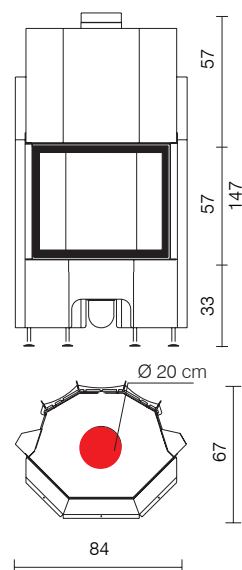

Cristal 45

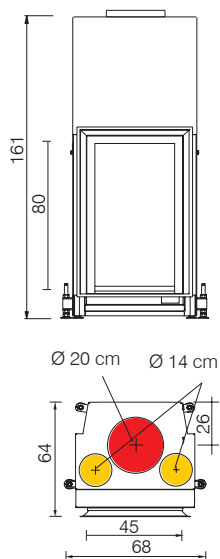

Cristal 76

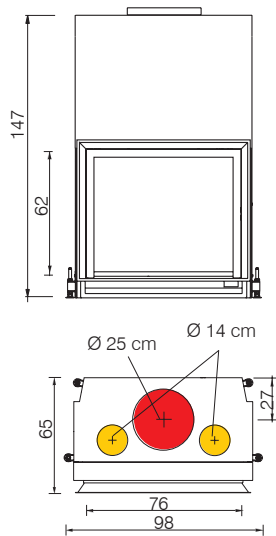

Cristal 90

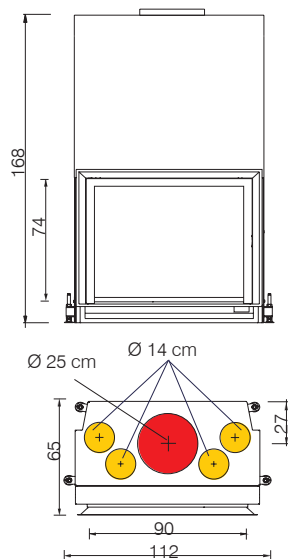

Double

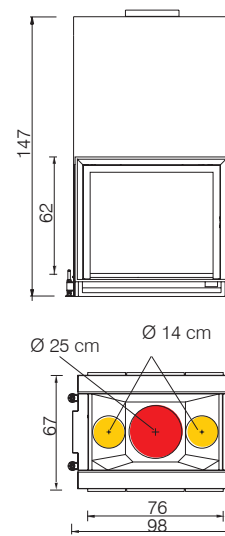

FIREPLACES

Flat 100

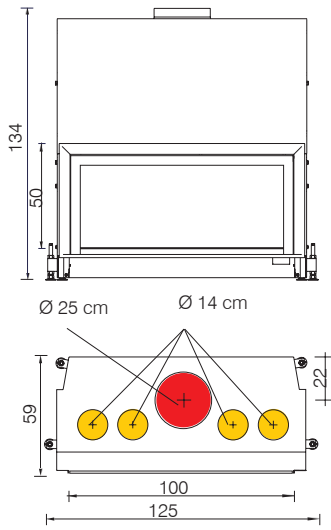

Flat 120

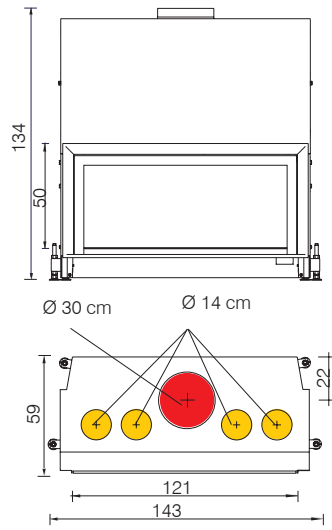

Titano Up2

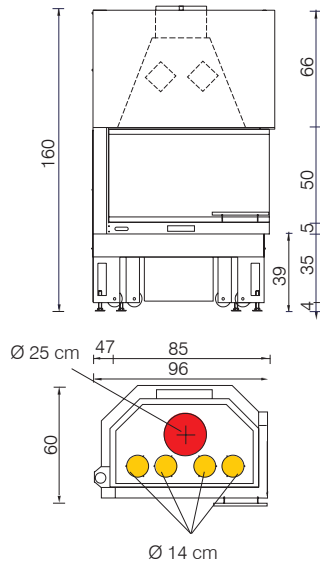

Forte Up2

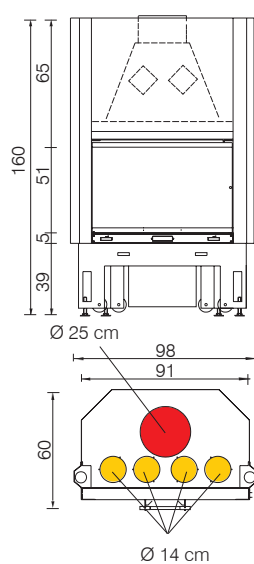

Status Up2

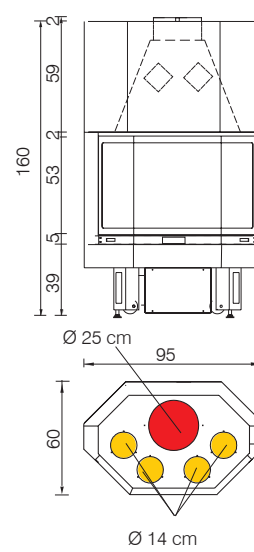

● External air intake

● Smoke outlet

● Hot air outlet

FIREPLACES

**IC Tekno
1**

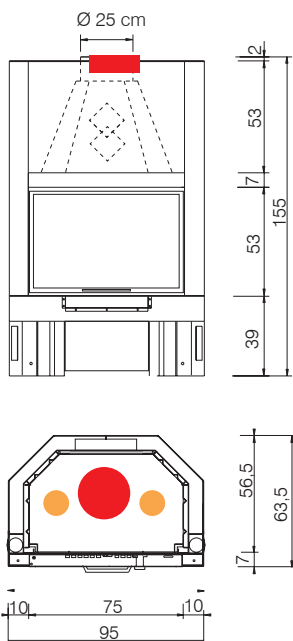

**IC Tekno
2**

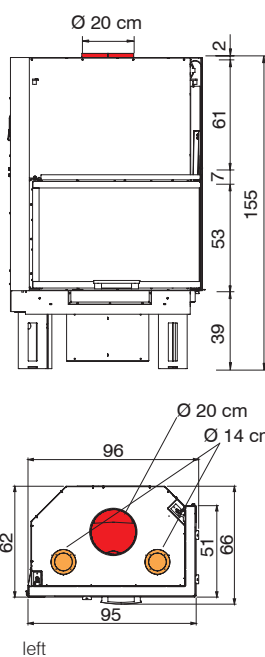

**IC Tekno
3**

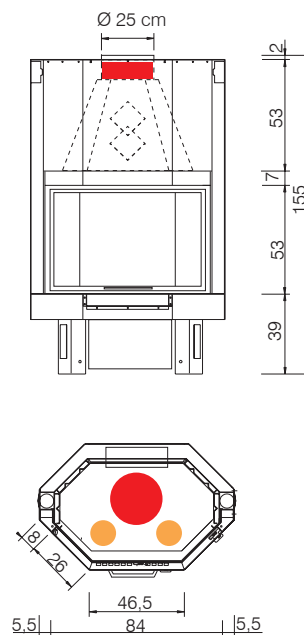

left

right

**Screen Up 80/2
Screen Evo 80/2**

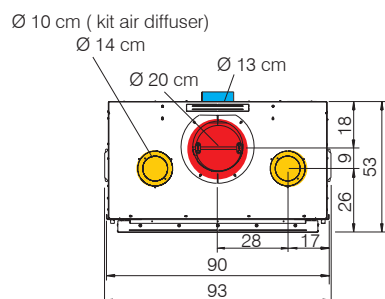
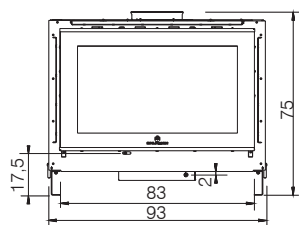

**Screen Up 100
Screen Evo 100**

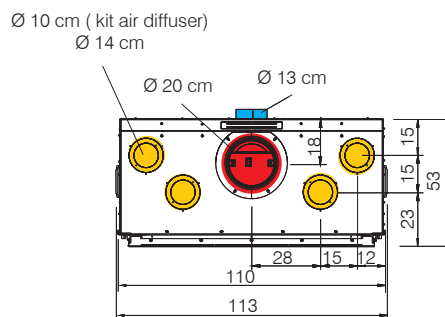
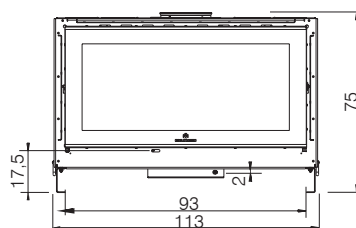

INSERTS

Firebox Deco

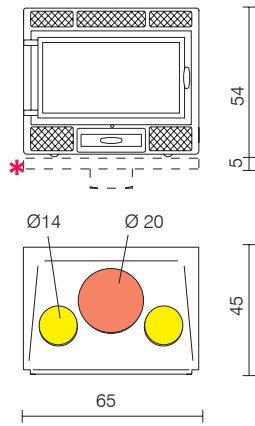

Firebox Riga
49 / 54

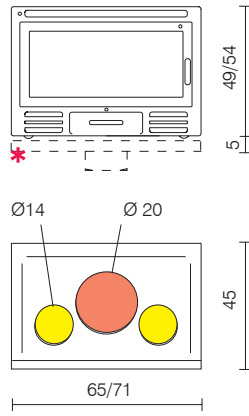

Kubicalor Ecostar

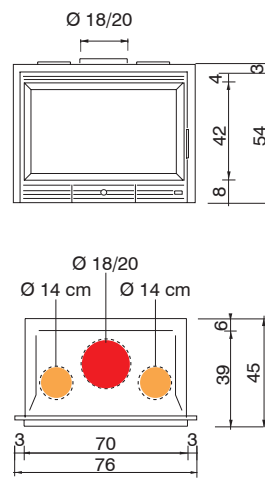

Kubicalor Piana

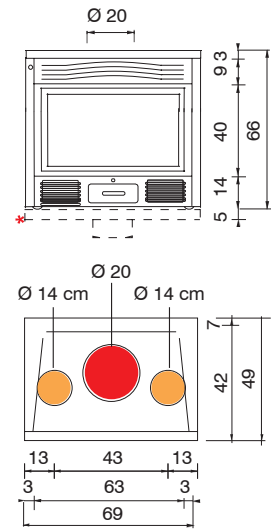

* External air intake Mechanism

Kubicalor Sprint

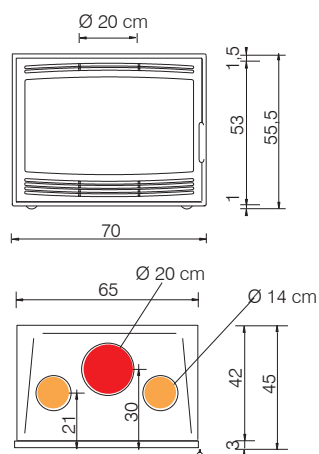

Firebox Luce Plus
54

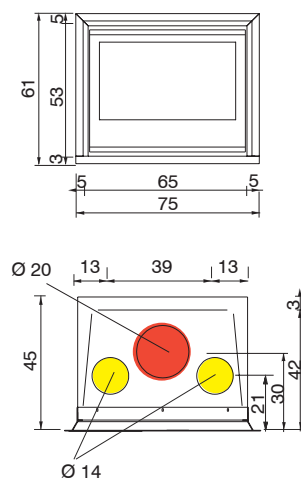

Firebox Luce Plus
62

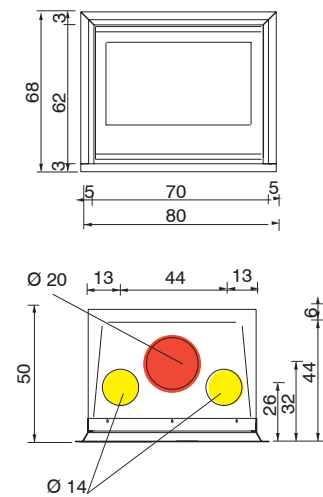

● External air intake

● Smoke outlet

● Hot air outlet

STOVES

Tally 8

steel / soapstone

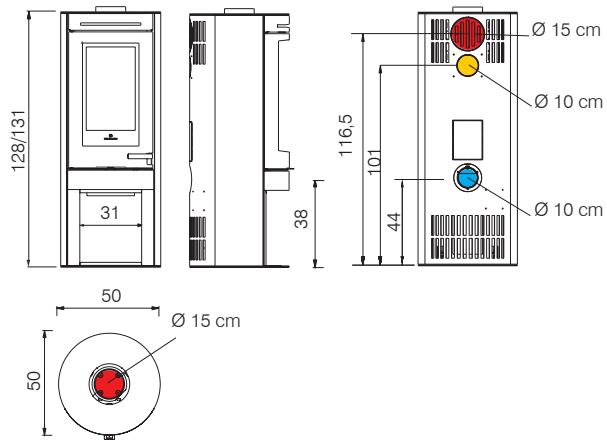

Tally 8 Up

steel / soapstone

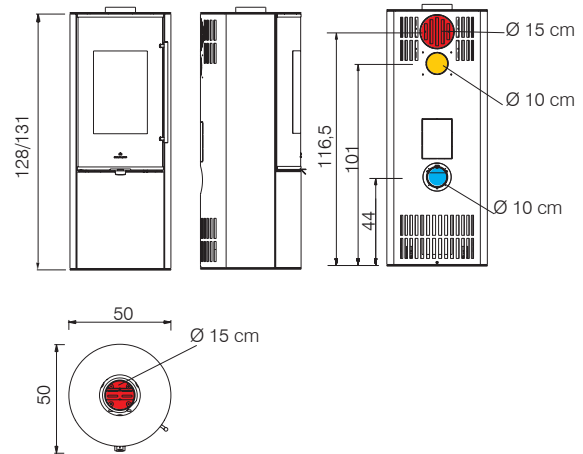

Tally 8 s / Tally 8 up s

steel / soapstone

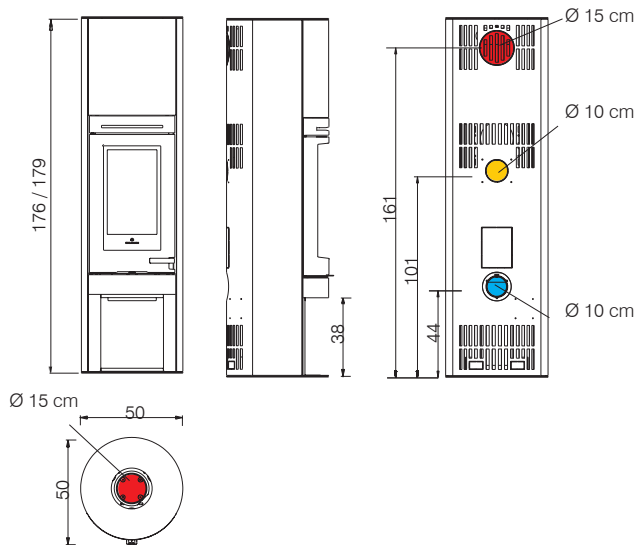

Dafne

Dafne Forno

Ninfa

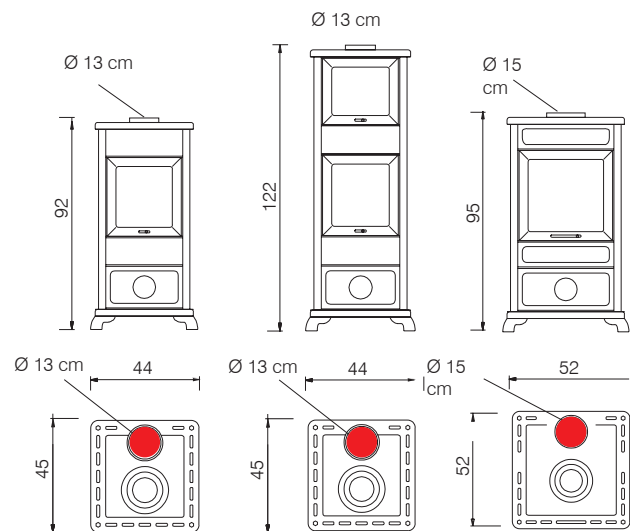

THERMO-STOVES

Fiord

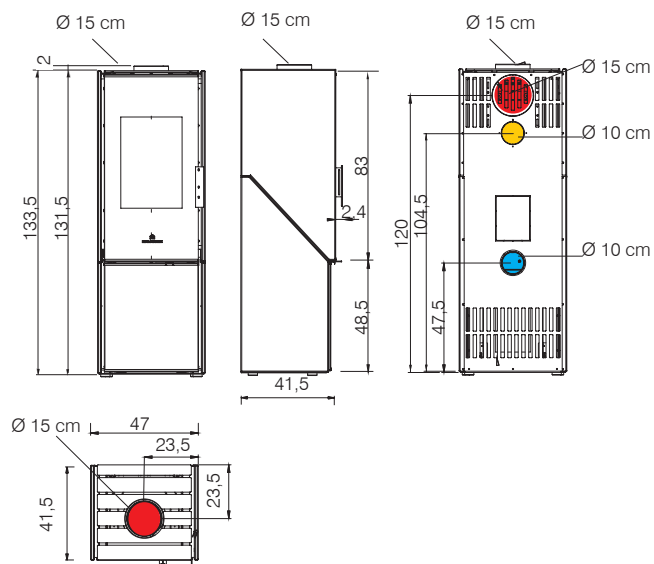

Flamma

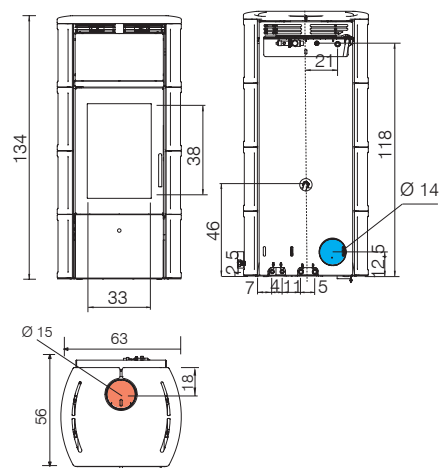

THERMO- FIREPLACES

Acquatondo 22 / Acquatondo 29

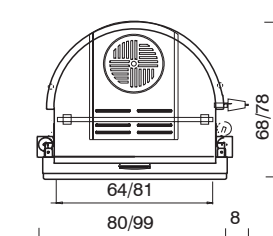
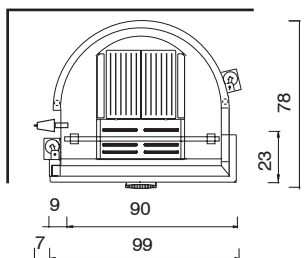
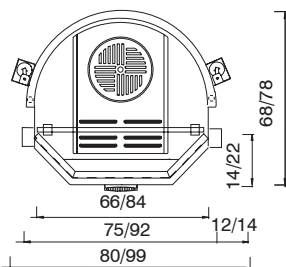
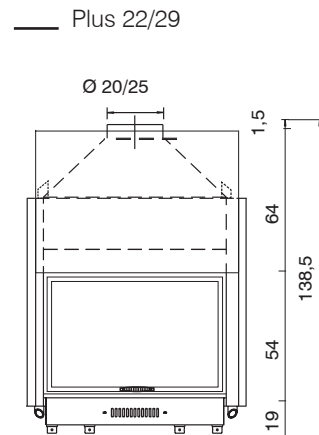
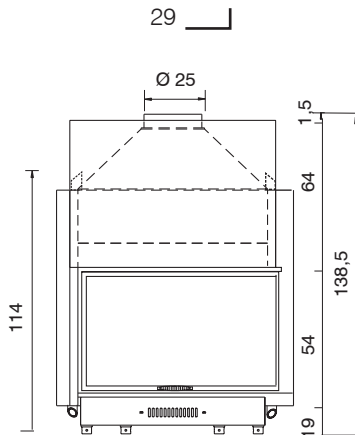
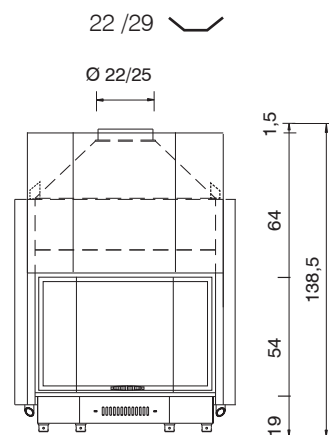

H₂Oceano 15 / 23 / 28

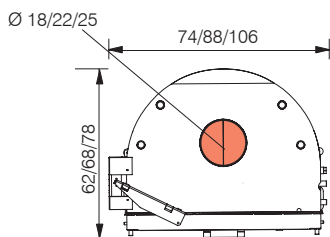
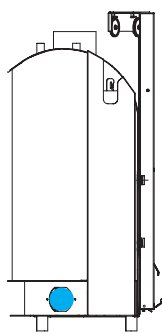
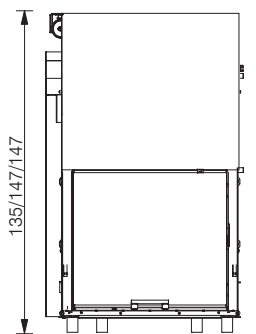

Idro 30

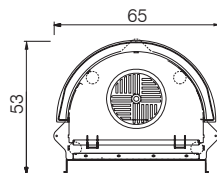
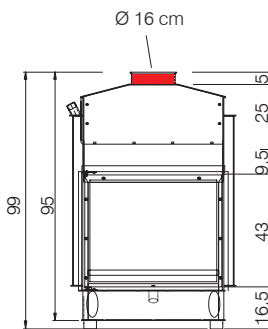

Idro 50

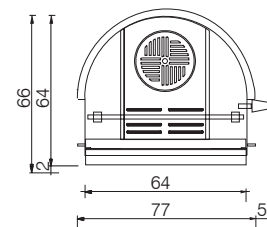
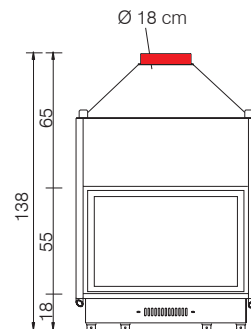

● External air intake

● Smoke outlet

● Hot air outlet



	Side Plus 50X50	Windo2 75 Windo2 95	Windo3 P50 Windo3 85	Cristal 45 Cristal 76	Cristal 90 Double	Flat 100 Flat 120	Airfire
kW	12,4	13,2 14,7	12 13,2	13 15	20,1 12	12 14	10
Kg/h	3,2	3,3 3,9	3,4	3,7 4,2	5,3 3,9	4 4,7	3,1
m³	325	345 385	315 345	340 390	525 315	315 365	260
%	81,8	84,6 81	75,9 84,6	76,1 77,9	82,6 67,6	65,3	71
cm	18 F ↑	20 F ↑	20 F ↑	20 F ↑ 25 F ↑	25 F ↑	25 F ↑ 30 F ↑	20 F ↑
cm	1x Ø 14 cm	4x Ø 14 cm	4x Ø 14 cm	2x Ø 14 cm 2x Ø 14 cm	4x Ø 14 cm 2x Ø 14 cm	4x Ø 14 cm	/
Kg	230	336 380	348 350	260 308	368 343	350 343	263 289
	•	/	/	/	/	/	/
	•	/	/	•	•	• •	•
	E 40x40x49h	E 67x36x44h 87x36x44h	E 38x70x51h 69x36x43h	E 37x35x78h 68x37x60h	E 82x34x72h 68x37x60h	E 100x38x50 120x38x50h	R 50x42x56h 50x43x56h
	•	•	•	/	/	/	/
Energy	A+	A+	A A+	A A	A+	A A	A

SYMBOLS KEY



kW
Power



Kg/h
Consumption
min/max



m³
Heatable volume
m³



Efficiency



Smoke outlet
↑ Top ↗ rear → side



Hot air outlet n° x Ø cm



Weight with packaging
Kg



Hearth
G Cast Iron, A Steel,
V Vermiculite, E Ecoveram

The heatable volume is calculated based on a requirement of 33 kcal/m³h. The same volume may therefore vary considerably depending on the level of insulation in the home, its exposure, the climatic area, etc.



Status Up2 Forte Up2 Titano Up2	IC Tekno 1 2 3	Screen Evo 80/2 Screen Evo 100	Screen Up 80/2 Screen Up 100	Firebox Luce Plus 54-62 Firebox Deco	Firebox Riga 49 54	Kubicalor Piana Kubicalor Sprint Kubicalor Ecostar
15,2	15,2	10,4 14,6	10,4 14,6	9,6	9,6	9,6
4,2	4,2	2,8 3,8	2,8 3,8	2,3	2,3	2,3
395	395	270 380	270 380	250	250	250
78	78	81,7 84,5	81,7 84,5	89,5	89,5	89,5
20 F ↑	20 F ↑	20 F ↑	20 F ↑	20 M ↑	20 M ↑	20 M 20 M ↑ 18/20 M
4x Ø 14 cm	2x Ø 14 cm	2x Ø 14 cm	2x Ø 14 cm	2x Ø 14 cm	2x Ø 14 cm	2x Ø 14 cm
287/292 305/310 293/303	248-251 248-252 238-243	167 200	165 197	126/144 124	111/144	153
•	•	/	/	• • •	• •	• • •
•	•	•	•	• • /	/	/
G 74x45x49h 64x46x38h 75x45x38h	G 75x48x50 78x48x54 75x48x50	E 73x40x44h 93x40x44h	E 73x40x44h 93x40x44h	G 55x38x29h 57x38x29h 55x29x29h	G 60x28x25h 55x28x29h	G 54x38x29 57x35x30 57x35x30
•	•	•	•	•	•	/
A	A	A+	A+	A+	A+	A+



Forced ventilation (V)



Natural convection (N)



Post-combustion system

Energy Energy efficiency classes

Energy A ⁺⁺ A ⁺ A B C D E F G	Energy A ⁺⁺ A ⁺ A B C D E F G	Energy A ⁺⁺ A ⁺ A B C D E F G
--	--	--



	Tally 8	Tally 8 Up	Fiord	Dafne	Dafne oven	Ninfa
kW	8	8	8	7,2	7,2	9
Kg/h	2	2	2	1,9	1,9	2,5
m³	210	210	210	190	190	235
%	85,6	85,6	85,6	82,6	82,6	78,3
cm	15 M ↗	15 M ↗	15 M ↑	13 M ↑	13 M ↑	15 M ↑
cm	1x Ø 10 cm	1x Ø 10 cm	1x Ø 10 cm	/	/	/
Kg	158/246 238/330+40	171/245 178/274+40	150	109	134	147
	/	/	/	/	/	/
	•	•	•	•	•	•
	V 29x23x39h	V 29x23x39h	V 29x23x39h	G 33x30x33	G 33x30x33	G 39x40x42
	/	/	•	/	/	/
Energy	A+	A+	A+	A+	A+	A

SYMBOLS KEY



kW
Power



Kg/h
Consumption
min/max



m³
Heatable volume
m³



Efficiency



Smoke outlet
↑ Top ↗ rear → side



Hot air outlet n° x Ø cm



Weight with packaging
Kg



Hearth
G Cast Iron, A Steel,
V Vermiculite, E Ecokeram

The heatable volume is calculated based on a requirement of 33 kcal/m³h. The same volume may therefore vary considerably depending on the level of insulation in the home, its exposure, the climatic area, etc.



	H ₂ oceano 15 H ₂ oceano 23 H ₂ oceano 28	Idro 30 Idro 50	Acquatondo 22	Acquatondo 29	Flamma
kW	16,6 23 28,1	14,8 16,6	23	28,1	14,2 23,6
kW _{H₂O}	8,2 13,3 17,4	8,6 8,2	13,3	17,4	9,7 14,6
Kg/h	4,4 6,1 7,5	4,3 4,4	6,1	7,5	3,5 6,1
m ³	435 600 730	385 435	600	730	370 615
%	83,1 82,2 81,5	75,1 83,1	82,2	81,5	87,4 84,6
cm	18 F 22 F ↑ 25 F	16 F ↑ 18 F	20 F ↑	25 F ↑	15 M ↑
Kg	246-251 cs 297-303 cs 302-308 cs	116-123 cs 171-189 cs	234-249 cs	302-311 cs	278 283 cs
l	75 100 130	30 60	70	90	40
	A/G 52x40x40h 60x50x40h 78x63x40h	A/G 49x40x43 56x47x51	A/G 56x47x50h	A/G 74x55x50h	A/V cm 33x34x38
Energy	A+	A A+	A+	A+	A+

- Forced ventilation (**V**)
- Natural convection (**N**)
- Post-combustion system

kW
Water

Water capacity

Energy Energy efficiency classes

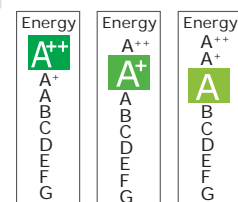

ANALYTICAL INDEX

Acquatondo 22	44
Acquatondo 29	44
Airfire	22
Cristal 45	14
Cristal 76	14
Cristal 90	15
Dafne	38-39
Double	15
Fiord	36
Firebox Deco	27
Firebox Luce Plus	27
Firebox Riga	28
Flamma	48
Flat 100	16
Flat 120	16
Forte Up2	20
Kubicalor Ecostar	30
Kubicalor Piana	30
Kubicalor Sprint	30
H2oceanò 15/23/28	42
IC Tekno	18
Idro 30	46
Idro 50	46
Ninfa	37
Screen Evo 80/2-100	24
Screen Up 80/2-100	24
Side Plus 50x50	12
Status Up2	20
Tally 8	32-33
Tally 8 s	35
Tally 8 Up	33
Tally 8 Up s	34
Titano Up2	21
Windo2 75/95	12
Windo3 85	10
Windo3 P50	10

EDILKAMIN S.p.A.

Reserves the right to change the technical and aesthetic specifications of the components illustrated in this catalogue, at any time and without prior notice and declines all responsibility for any printing errors in this catalogue.



 **EDILKAMIN**
STUFE_CALDAIE_CAMINETTI



AL 945297 5.10.19/A

